

ବଓ୍ୟାନିକା



OFFICE OF THE ORISSA STATE HANDLOOM WEAVERS COOP.SOCIETY LTD
PANDIT JAWAHARLAL NEHRU MARG, BOYAN BHAWAN, BHUBANESWAR-1
TEL : (Office) - (0674) 2395387, 2390741, 2391178, Fax – 0674 – 2530553
Email :- boyanikabbsr@sify.com, Website- www.boyanika.com

TENDER PAPERS

FOR

NATIONAL HANDLOOM EXPO 2012

SPONSORED BY

**DEVELOPMENT COMMISSIONER (HANDLOOMS),
MINISTRY OF TEXTILES, GOVERNMENT OF INDIA**

**AT – UNIT-III, IDCO EXHIBITION GROUND,
BHUBANESWAR**

FROM Dt.06.01.2012 TO 29.01.2012



TENDER PAPERS FOR THE WORK OF
NATIONAL HANDLOOM EXPO – 2012
AT – UNIT-III, IDCO EXHIBITION GROUND,
BHUBANESWAR-751001

GENERAL CONDITIONS :
DETAILS OF SPECIFICATIONS :
SCHEDULE OF QUANTITIES :
COST OF TENDER PAPER : Rs. 10,000/-(Rupees Ten thousand)only
per each set
ISSUED TO : M/s
.....against
Money Receipt No.....
Dt.....

CASHIER

LAST DATE & TIME
FOR RECEIPT OF TENDER : 14/12/2011 LATEST BY 3.00 P.M
DATE & TIME
FOR OPENING OF TENDERS : 14/12/2010 AT 4.00 P.M.

PLEASE DELIVER AT

“BOYAN BHAWAN”
ORISSA STATE HANDLOOM WEAVERS’ CO-OPERATIVE SOCIETY LTD,
PANDIT JAWAHARLAL NEHRU MARG, BHUBANESWAR – 751001



TENDER NOTICE

No.3218

Dated 07/12/11

Sealed tenders are invited from reputed Decorators / Contractors for construction of Exhibition Pavilions/Stalls, Front Gate and Electrification Works of proposed "National Handloom Expo 2012 to be held at Unit – III, IDCO Exhibition Ground, Bhubaneswar from 06/01/2012 to 29/01/2012.

The Expo sponsored by the Development Commissioner for Handlooms, Govt. of India, New Delhi, is being organized by Orissa State Handloom Weavers' Co-operative Society Ltd (Boyanika), Bhubaneswar. Detailed tender notice can be had from the office of the Managing Director Orissa State Handloom Weavers' Co-operative Society Ltd, Bhubaneswar on payment of Rs10,000/- (Ten thousand) only (Non-Refundable) during working hours. The documents can also be available / downloaded from the website www.boyanika.com and submitted by due date and time along with the tender paper cost in shape of Bank Draft / Bankers Cheque on any Nationalized Bank drawn on in favour of Orissa State Handloom Weavers Co-operative Society Ltd payable at Bhubaneswar.

Tenderers are required to deposit Rs.2,00,000/- (Rupees Two lakhs) only in the form of Bank draft/Bankers Cheque on any Nationalized Bank drawn in favour of the Orissa State Handloom Weavers' Co-operative Society Ltd. Bhubaneswar as Earnest/Security Deposit.

Tenders can be submitted latest by 3.00 P.M. on 14/12/11 at Office of the Managing Director, Orissa State Handloom Weavers' Co-operative Society Ltd., Bhubaneswar.

Tenders must be submitted along with certificates of execution of similar work done with National/Special/Mini Handloom Expo/any other Govt. Fair Authority of the country along with other documents as mentioned in detailed Tender Notice like PAN No./ITCC/STCC/VAT Clearance etc.

Tender will be opened on 14/12/11 at 4.00 P.M. in the presence of Tenderers at Boyan Bhawan, Orissa State Handloom Weavers Cooperative Society Ltd., Pandit Jawaharlal Nehru Marg, Bhubaneswar – 751001.

The works shall have to be executed within 20/12/2011 to 03/01/2012 and handed over by 4th January 2012 and only those tenderers who have the necessary expertise to execute the job within the stipulated time should submit the tenders on the above address.

The undersigned reserves the right to accept or reject any or all the tenders without assigning any reason thereof.

**Sd/-
MANAGING DIRECTOR**



ORISSA STATE HANDLOOM WEAVERS COOP. SOCIETY LTD
PANDIT JAWAHARLAL NEHRU MARG, BHUBANESWAR – 751001

GENERAL CONDITIONS

1. Sealed Tenders are invited from reputed Decorators / Contractors for construction of Exhibition Pavilion/Stalls/Front Gate and Electrification Work for the proposed National Handloom Expo to be held at Unit-III, IDCO Exhibition Ground, Bhubaneswar from 06/01/2012 to 29/01/2012.
2. The duration of Expo shall be 24 (Twenty four) days. However, in case it is extended up to 3 (three) days, no extra payment shall be made to the Contractors. In case the Fair extended for more than three days extra payment for each extended days(s) beyond 27 days shall be made at the rate not exceeding proportionate cost for 27 days. On completion of the Expo, the Contractor shall have to take away all the materials within 3 (three) days and shall have to vacate the site. He shall have to pay 25,000/- (Rupees Twenty five thousand) only per day for the days he occupies for vacating the site beyond the period allowed therefore. It is the responsibilities of the Contractor to obtain clearance certificate from the Complex Authorities regarding clearance of the complex.
3. The expo premises shall be formally made available to the Contractor by Expo Authority on, as is where is basis on 20th December 2011. The construction work must start immediately at site on the same day and be completed and handed over to the expo Authorities formally by 5.00 P.M. on 4th January 2011 positively. The progress of the work shall be checked and supervised by officers duly nominated by the Expo Authority to ensure that the work is done as per the specifications and time schedule. Tenderers are advised to inspect the site for physical condition before tendering.
4. In case any portion of work is not completed as per laid down specifications and handed over to the Expo Authorities on the due date, penalty up to 5% on the total value of work allotted/awarded will be imposed per day by the Expo Authorities.
5. The volume and number of works may vary at discretion of the Expo Authority; up to 40% of the contracted work either way & final payment to the contractor shall be regulated on the basis of actual work executed and on the rate(s) initially approved. For extra fittings contractor will have to quote rate separately. For all such extra fittings, the Expo Authority reserves the right to pay the lowest of the rates quoted by the competing contractor.
6. The Contractor will be responsible for up keep and maintenance of the entire work done by him till the closing of the exhibition, for which, no extra payments shall be made. He shall therefore, have to ensure adequate number of carpenters/helpers to the satisfaction of the Expo Authority. Breakages and damages in any work shall immediately be settled and no extra payment will be made for any damage, breakage or loss on account of any reason or natural calamities. Lay out plans etc of the site shall have to be provided by the tenderers. Managing Director, Orissa State Handloom Weavers' Co-operative Society Ltd, Bhubaneswar reserves the right to reject any or all tenders without assigning any reason or to accept any portion of the tender and award the remaining work to any other Contractor.

**Accepted
Contractor**



7. No part of the contract will be sub-let without the prior written permission of the Managing Director, Orissa State Handloom Weavers' Co-operative Society Ltd./Expo Authority.

8. It shall be the responsibility of the successful tenderer/contractor to obtain requisite permission for water, electricity power, coverage and other essential connection at the Expo Ground for the duration of the Expo i.e. from the date the ground is handed over to the contractor for construction to the date the ground is handed over back to the Local Authority from whom it has been taken on rent. It shall also be responsibility of the contractor to liaise with the concerned authorities and arrange all the civil, electrical connection and other amenities that may be required for running of the Expo. However, security deposits, if required, shall be made by the Expo Authority. Letters to the concerned authorities shall also be addressed by the Expo Authority. Security deposits, installation charges and consumption charges for all civil and electrical connections for the duration of the Expo while shall be paid by the Expo Authority, the contractor will however, have to pay all security deposits, installation & consumption charges, both civil and electrical for the duration he takes over the ground to the time he formally hands over the complete work of the Expo to the Expo Authority.

9. In regard to electrical fittings etc, the contractor shall have to engage qualified licensed Electrician/Contractor entitled to erect, handle and maintain high tension supply line and its up keep and maintenance.

10. The contractor shall not use any materials other than those specified in tender without the prior permission of the Managing Director, Orissa State Handloom Weavers' Co-operative Society Ltd., Bhubaneswar/Expo Authority.

11. No advance shall be paid to the contractor till completion of the work and handing over to the Expo Authorities, but part payment may be considered to the contractor during the Expo on mutual agreed upon between the contractor and Expo Authority. Final payments will be made only after completion of the Expo and handing over the complex to the Complex Authorities (IDCO).

12. All the Tenderers should fill the rate tendered in figures as well as in words. The tender form may be filled in English and all entries made by hand and written in ink. Over writings in rate is not permitted. All corrections should be attested by the tenderers with his initials as many times as corrections occur. Each page of the tender form and other related papers submitted there- with should be signed by the Tenderers. Any discrepancy in the rates written in figures and words, then rates written in word is final. Similarly discrepancy in the rates quoted for unit rate and total amount, then the rate quoted for unit is final.

Accepted

Contractor



13. The Tenderers are required to deposit an earnest/security money of Rs.2,00,000.00 (Rupees Two lakhs) only. The amount of earnest/security money will be accepted only in the form of Demand Draft/Bankers Cheque drawn in favour of the Orissa state Handloom Weavers' Co-operative Society Ltd., Bhubaneswar. Only those tenderers who have necessary expertise in the execution of the job within the stipulated time should submit the tenders. The tender without earnest/security money shall not be accepted.

14. While submitting the tender, the tenderers should submit the following:-

- i. Authentic proof of the work done of similar nature and value with any Govt./Fair Authority of the Country/ National Handloom Expo etc in a single work order and its certificates etc, within the last 3 financial years inclusive of current financial year.
- ii. Pan No., Income Tax, Sales Tax/VAT Clearance Certificate etc along with latest Service Tax deposit Challan as required for the Tender process.
- iii. Proof of financial status and credit worthiness of the firm from any scheduled Bank, indicating the financial capacity of the party to complete the work without any advance. The Authority reserves the right to ask for Bank Guarantee of 30 % (thirty) of quoted value to the successful/selected tenderer.
- iv. A list of works of similar nature executed given details of their magnitude, cost and time within which works were completed.
- v. Copy of valid registration, ITC, STC/VAT, Service Tax Certificates from concerned authorities.
- vi. The Tenderers shall have to furnish the license of the electrical contractor to entitle to take up such work along with his willingness.
- vii. The tenderer shall have to furnish the willingness of a registered Security Agency along with their Registration Certificate and other required documents.

Any tender not accompanied by requisite documents mentioned herein above is liable to be invalid.

The Tender shall be finalized on the following principles.

- a) Financial Involvement = 50 Points
(Full 50 Points will be allotted to the lowest Quoted Tenderer & proportionate reduced Point will be allotted to the other Tenderers)
- b) Credentials = 50 Points
(Full 50 Points will be allotted to the Tenderer having minimum 3 nos. of single Work Order of Rs.20.00 (twenty) lakhs or above from any Govt. Deptt./Agencies only in last 3 years & proportionate Points will be allotted to the other Tenderers, but no Point will be allotted to the single Work Order of less than Rs.20.00 lakhs.)

The Preference will be given to the Tenderers as per the points obtained.

**Accepted
Contractor**



15. The Managing Director, Orissa State Handloom Weavers Cooperative Society Ltd. Bhubaneswar/Expo Authority is not bound to accept the lowest tender and reserves the right to inspect / verify the stock of materials required for this work, in Godown of tenderers by nominating a Committee to ascertain the credibility of the firm. Further the undersigned reserves the right to reject any or all tenders without assigning any reasons. Conditional tender in any form whatsoever will not be qualified/consider and will be liable for outright rejection.

16. The successful tenderers shall immediately and not later than the next day of intimation of acceptance of tender, sign an agreement on Non-judicial stamp paper of appropriate value. Failure to do so shall give the Managing Director, Orissa State Handloom Weavers' Co-operative Society Ltd. Bhubaneswar/Expo Authority the right to revoke the acceptance of the tender without further notice to the tenderers, forfeit the earnest money deposits and award the work to any other contractor.

17. The successful tenderer shall have to take up the sanitary and water supply work within first 5 days time to avoid unhygienic condition inside the Expo ground.

18. The Earnest/Security Money of successful tenderers will be retained for successful completion of the contract and shall be returned only after Expo is over.

19. The Managing Director/Expo Authority will read and include Managing Director, Orissa State Handloom Weavers; Co-operative Society Ltd., Bhubaneswar who is organizing Expo.

Sd/-
Managing Director
Orissa State Handloom Weavers'
Co-operative Society Ltd.
Bhubaneswar

Accepted

Contractor



STANDARD SPECIFICATIONS FOR THE INTERIOR AND EXTERIOR DECORATION WORK OF THE EXHIBITION PAVILIONS / STALL FOR NATIONAL HANDLOOM EXPO.

DETAILED SPECIFICATIONS

The structures should be steady and neatly finished. The basic structure is to be constructed with Balli Pillars and the rafter and purlins with bamboo at a distance not less than 2' (refer drawing No.1). The roof is to be covered with good quality tarpaulin and should be without any imperfection and holes to prevent leakages of water in the advent of rains in order to protect the products of the participants. Sufficient slope is to be provided to ensure water drainage in case of rains. The front should have minimum of height of 13.5' from the ground and the back should have a minimum height of 10.5'. The platform is to be made of 3/4" ply block board and should be at 1.5' height from the ground according to site conditions. Proper bracings at a distance of 2' (both vertical and horizontal) should be constructed to give platform enough strength and to withhold the anticipated crowd to the Expo. New Vinyl/synthetic carpet Flooring of approved quality should be laid over the platform. The gap between ground and platform should be covered with 4-mm ply.

The back and front side walls should be made of 4' frame work of not less than 3" x 1" vertical and at least 1" horizontal frame work covered with 4 mm. Ply board on both sides. Dividing walls should also be made as per the above specifications. The minimum height of the walls from platform should be 8'. The new white cloth ceiling with wooden framework should be fixed at 8.5' from the platform. A step at the entrance should be provided to enable the visitors to the Expo (as per the drawing to have an easy access to each pavilion). The front flex fascia should be as per approved design. The entire backsides of the stall should be fixed with 4mmply with wooden frame work..

Sale counter and cash counter is to be fabricated either with iron folded table or with 18 mm. Commercial block board/wooden post and shelve/similar nature of material as per site requirement and properly painted with approved shade colour. Height should be 36" and the width 2'. The length of the counter will not be less than 16' in each 250 Sft Pavilion/Stall.

One cash counter of 3' x 4' x 2.5' shall be provided in addition to the stipulated sales counters to each of the pavilion/stall with a provision of drawer and with a provision of chair for the cashier. Proper locking should be provided with cash counter. 4 racks should be provided in each pavilion and should be fabricated either with iron folded racks or with commercial block board/wooden post and shelves/similar material of size 8'x4'x1.5' with 5 shelves each (refer drawing). The racks to be provided should be properly painted with approved quality paints.

Accepted

Contractor



For each pavilion 2 nos. fire Extinguishers as approved by Fire Authority shall have to be installed. One each for common and another suitable for electrical fire along with fire extinguishers for each Pavilion, 2 nos. of buckets (specially designed for fire fighting) containing water in one and sand in another to be installed. They should be installed at places as directed by the Fire Authority. The Contractor shall have to obtain the Fire Safety Certificate at his own risk from the concerned fire authority. Electrical light and fan fittings to be provided with necessary wiring on main line separately for (a) fan (b) light (c) night lamp, distribution and point wiring including switch, main switch etc., using ISI standard wire and light fittings complete as may be approved by the local electrical authority. All fittings should be properly focused to enable enough/proper lighting at the sales counter and general lighting at the pavilion.

The following fittings will be provided:

Pavilion size (in sq. ft.)	Tube lights 40W & above	Ceiling Fan	Extra Night Lamp-cum-Inverter connection out of the provision as under.
1	2	3	4
250	8	1	1
500	16	2	2

(Contractor should provide requisite number of Invertors as stand by so as to provide connections to the number of lights as mentioned under column-4 in the case of power failures. Cost of the invertors should be covered while quoting per sq. ft. rate for the pavilions. The capacity of the invertors must be such as to meet the load of the installations under Col.4).

All electrical works including fittings and fixtures and wiring must be done through a licensed Electrical Contractor borne in the current approved list of PWD (Electrical/CPWD, etc) who will submit and obtain necessary approvals and submit TEST FORM to Executive Engineers, PWD/ Electrical Inspector Govt. of Orissa (Electrical for Power connections).

Accepted

Contractor



The Contractor shall quote rental for the following items for the duration of the Expo. The rental shall be inclusive of all wiring, trenches inclusive of all cabling from switch transformer to boards, distribution boards for each block of 10 shops to main panel board for three phase meter for requisite power load inclusive of all equipment structures and fittings as required for the electric supply and contact from the supply terminal to and inclusive of distribution board for a block of 10 shops as approved. Installation of transformer(s) shall also be the responsibility of the contractor. He shall also supply fix and maintain HRC fuses. TP switches fuse kits, DP switch fuses, porcelain Kit-kat etc., required for the distribution of power to individual shops. Complete safety measures shall be adopted and all cable joints etc., properly earthed with copper conductor and sufficient earthing pits provided under direction and approval of the Managing Director/Expo Authority. The rental shall include constant attendance of the qualified and experienced electrician for the maintenance and service (entirely at the cost of the contractor) as required, i.e. minimum 6 numbers of electrician in A shift (5 am to 1 pm), 12 numbers of electricians in B shift (1 pm to 9 pm) and 6 numbers of electricians in C shift (9 pm to 5 am) in proper uniform bearing the logo “ELECTRICIAN OF EXPO” having license / certificates to entitle to handle and maintain such electrical arrangements. The temporary electrical connection and consumption charges required for construction period shall be obtained by the contractor at his own risk and cost, in case it is provided by the Expo Authority then consumption charges for the duration of the Expo shall however be borne by the Contractor.

Besides the tube light fittings, spot lights, fans etc. mentioned in the general construction, the contractor has to provide the following lighting arrangements. Providing and fixing Halogen light outdoor type water proof fittings complete the under ground wiring and steel fixing brackets of 75mm x 6 mtrs high (‘A’ class steel poles duly painted black or as per instruction of the Managing Director/Expo Authority with two/four) 1000 watt halogens (quote separately for two/four). Providing and fixing 4’ long fluorescent tube light on new steel patties in the parking area. WC bathroom, etc., as per the instructions of the Expo Authority. The number of lights should be sufficient to avoid darkness and as per instructions given by Expo Authority. Complete public address system with a powerful (PA 60) switch over type amplifier with 2 microphones, tape player and 20 numbers loudspeakers strategically placed on the ground and parking area is to be provided. A full time operator and a full time announcer as approved by Expo Authority shall be provided by the Contractor to operate the Sound System, play cassettes of recorded instrumental music and to announce the required information’s as & when required. The control, amplifier etc will be located in or near the office.

Accepted

Contractor



Construction of office is same as Exhibition pavilion except no rack, counter and new Vinyl/synthetic carpet Flooring. Sufficient office furniture/fixtures and other office items as instructed, at site by Expo Authority should be provided at the Pavilion by the contractor without any extra cost. Office furniture shall include (1) four sets of executive sofas (2) one fridge (3) 5 nos. of tables (4) 30 nos. chairs (5) 2 room coolers/room heaters (6) one 21" colour TV set. (7) 1` executive chair with table, 5-semi executive visitors chair for office of the officers-in-charge of Expo (8) 20 nos. of large size good quality Turkish towels of white/cream colour, (9) 40 lts. of mineral water per each day for the entire period of expo (10) tray/glass/jug/flask etc. Announcer Cabin will be provided therein as directed. Additions/alternations may be suggested at the site by the Expo authority, for which, no extra payment shall be made to the contractor. A full and half size steel almirah with lock and key is to be provided. A separate urinal attached to the office should be provided to use by officers . Apart from the above, Contractor shall have to provide one set of Computer with one Programmer-cum-Operator for full time of Expo for required Data Entry and official works.

Construction of post office is same as Exhibition Pavilions except racks and new Vinyl/synthetic carpet Flooring. One counter with glass window, eight chairs and a drawer with locking facility will have to be provided. The counter shall be 300cm long or as directed by Postal Authority including lighting as direct. Two pedestal / ceiling fans should also be provided in the Post Office.

Construction of Bank should be as per construction of Post-Office.

A Theme Pavilion as per specification and as per approved design with provision of minimum 2500 sft usable area for display of looms/fabrics and instruction given by Expo Authority at site. The size of structure will be 90 Ft. dia in base portion and 40'Ft to 60 Ft. height for which reference drawings have been enclosed herewith. The structure should be strong and steady and neatly finished. The basic structure is to be constructed with bally pillars and bamboos with wooden framework covered with ply/approved design flex/ plaster parish and clothes etc..

Construction of Police/Security office should be as per construction of Post office as above.

A Garage for fire tender is to be provided with GCI sheets over steel pipe structure with a difference in height, i.e. 24' in front and 20' in the back. Dimension of the garage should be 24' x 32'. There is no plywood work except for fascia. Front side will remain open and rear wall should be kept closed with GCI sheets (partition wall, roofing will be made out of GCI sheets) including lighting as directed. Two pedestal fans; five chairs and 4 folded beds are to be provided. Arrangement for a tent accommodating four beds near the garage shall also have to be provided.

Accepted

Contractor



Construction of First-Aid Centre shall be as per office with provision of one medical bed, one fridge and deep green door /window cotton and as directed by the First-Aid Authority.

The above specifications are the minimum requirements. Further instructions on the spot will be given by the First-Aid/Fire/Bank/PO/Police/WSC Authority in case any deviation is deemed necessary. No extra payment shall be made to the contractor for all such addition/alterations.

KIOSKS: Size of each kiosk will be 20' x 20' x 8' / 10' x 10' x 8' with GCI/Tarpaulin roof and shall have facia of 4' on all the four side. Each kiosk should be provided six tables of 4'x4'x4' size, eight tube lights with power connection, two drum of 6' height to store disposable/wastes and power connection wherever required (the number of extra power points with connections and to the stalls where such connections are to be provided shall be intimated at site by the Expo Authority). Electrical wirings inside the kiosks should be done on conduct piping so as to avoid the fire hazards. Flooring should be leveled and raised with 3" bricks and false ceiling to be provided with wooden batten frame work with flat AC sheet covering.

A temporary shamyana with proper stage and dais of size 50 Ft. X 40 Ft of 4' height. along with a ramp of adequate length should be provided with approved colour woolen carpet, 15 nos. of new decorative/ attractive sofa, 25 nos executive chairs with white Turkish towels and 1000 nos chairs, one attractive podium etc., for the inaugural/ closing function and seminar/ work shop/Buyer-Sellers meet, which will be remained for entire period of the Expo.

All the material used for construction of Exhibition pavilions/kiosks etc., should be meet the approval of the Expo Authority. Not withstanding any thing contained in the aforesaid clauses and in the accompanying schedules, the Expo Authority is competent to effect change of the venue and to the schedules accordingly or even cancel the Expo before the work is formally awarded and the contractor will not have any claim against the Managing Director for the preliminary work(s) or any other expenses incurred by the contractor in connection with this tendering for the work and further proceedings thereon until such alternation or cancellation.

Sd/-
Managing Director
Orissa State Handloom Weavers'
Coop. Society Ltd. BBSR

Accepted

Contractor



SCHEDULE OF QUANTITIES FOR THE QUOTATION
ON NATIONAL HANDLOOM EXPO – 2012
AT UNIT – III IDCO EXHIBITION GROUND, BHUBANESWAR.

Hiring Charges / Rates should be quoted inclusive of transportation but exclusive of taxes if any, as per required specification in the tender:-

Sl. No.	Particulars	Number of required units	Rate per unit (in figure and words)	Total amount
1	2	3	4	5
1	Pavilions/Stalls with all provisions as per schedule.	180 nos. (Measuring 250sft)		
2	Construction of Auditorium-cum-Office as per schedule.	1 Unit (2500 Sft.)		
3	Construction of Post Office/Bank/Police Post/ First Aid/Security etc.	10 Units (250 Sft each)		
4	Fire Brigade Garage as per schedule	One unit		
5	Theme Pavilion as per the schedule and approved design.	One Unit		
6	Providing temporary stage with shamiyanna. Temporary bamboo structure with tarpaulin and cloth ceiling, walling etc. for 1000 persons along with 15 sofas, 1000 nos. chairs, 25 nos. executive chairs with 25 nos. of white new Turkish towels for the inaugural/ closing functions/ seminar/ work shop/buyer seller meet. A temporary urinal to be provided along with proper sanitary arrangement.	2 units.		
7	Providing and fixing of KIOSKS including lighting at suitable places as per schedule. a) 20' x 20' x 8'	3 Nos.		
8	Providing gate as per design given in reference drawing.	3 Nos.		
9	Front Facia as per approved design. (Unit – One Sft.)	2250 Sft.		

Accepted

Contractor



Sl. No.	Particulars	Number of required units	Rate per unit (in figure and words)	Total amount
1	2	3	4	5
10	Display ballon of 10' dia at Approved height (permission from Concerned authority for installation Shall have to be obtained by the Contractor).	1 No		
11	Providing of New Appliqué umbrella for electrician post for entire period of Expo.	12 Nos.		
12	Security Guards (Rate to be quoted per No. per shift.	780 Nos.		
ELECTRICAL ITEMS				
1	a) Providing all electrical connections, fittings and fixtures as per schedule. Electrical inspection/ Clearance Certificate shall have to be obtained from the concerned authority by the contractor.	One Unit		
	b) Maintenance of electrical system by engaging 24 nos of qualified/licensed electrician in shift wise duty as per schedule.	528 Nos.	(Rate to be quoted each per day.)	
2	Street and Parking lights as per schedule.			
	a) 2 halogens	15 Units		
	b) 4 Halogens	5 Units		
	c) 2 Metal Halide	20 Units		
	d) 4 Metal Halide	20 Units		
3	Tube lights (Only Company make, no assembled fittings shall be allowed) as per schedule (8 tube lights – one Unit.)	200 Units		
4	Public announcement system as per schedule with full time announcer and full time operator.			
	a) Hiring charges of systems for entire period of expo.	1 Unit		
	a) Charges of announcer for entire period of expo. (daily 8 hours)	1 Unit		
Accepted Contractor				



Sl. No.	Particulars	Number of required units	Rate per unit (in figure and words)	Total amount
1	2	3	4	5
5	Providing of decorative ornamental lights around the Expo Ground/ boundary wall along with wiring. (Zero watt bulbs/running bulbs 1000 nos. – One Unit. 100 KVA DG Set. (excluding fuel) Rate of consumption of fuel per hour	30 Units.		
6	along with cost of fuel to be furnished.	2 Nos.		
7	Illumination of the entire front compound wall of the Expo ground.	LS		
8	Providing of 300 nos. decorative appliqué lamp as per approved location.	LS		
9	Artificial (plastic) Palm/Coconut Tree with lighting. (Unit – 1 no.)	15 Nos.		
10	Sky Tracker (400 Wt.)	1 Unit		
WATER SUPPLY AND SANITARY				
1	Cleaning of entire premises of Expo ground (western 1 and 2 of the Unit-III IDCO Exhibition ground) and lifting of entire debris stacked in the ground from south compound wall to north compound wall and western compound wall to central portion of the ground by truck/tractor load from the ground to the dumping yard and erection of GCI sheet partition in the portion of the bathing complex.	LS		
2	Bathing complex- Construction of 2 numbers temporary water vat of size with inner dimension 20'-0" length, 4'-0" width and 3'-0" depth with 10" brick work finished with plastering and punning complete in all respect with a provision of a cemented platform either with brick soling with cement mortar or RCC slab of size 20'-0" x 6'-0" linking to water vat.	2 Nos.		

Accepted



Contractor

Sl. No.	Particulars	Number of required units	Rate per unit (in figure and words)	Total amount
1	2	3	4	5

3 Water supply- Placing of 4 nos 1000 Ltr capacity PVC water tank in different locations and one 2000 Ltr capacity PVC tank near bathing complex, linking to main PVC tank to toilets and bathing vats as required complete in all respect including all cost of material and labour cost. LS

4 Sanitary Arrangement -
a) Construction of 50 nos toilet blocks of size 3'-0" x 3'-0" with fixing of Indian style pan in brick base work with plastering and punning and four side GI sheet partition minimum upto 7' height with provision of GI sheet/ply shutter with locking arrangement to maintain proper privacy. All the toilet blocks to be provided with water tap connecting to 2000 Ltr water tank installed near bathing complex. All the toilet blocks to be linked with construction of a temporary septic tank of size 10'-0" dia and 8'-0" depth with proper arrangement to avoid foul gas, with all cost of material and labour charges. LS

Accepted

Contractor



Sl. No.	Particulars	Number of required units	Rate per unit (in figure and words)	Total amount
1	2	3	4	5
	b) Construction of a toilet of size 6'-0" x 3'-0" linking to Expo office either with brick work or ply work cladding with ceramic tiles in floor and wall upto 5' height with provision of a toilet pan, urinal basin, wash basin, mirror, towel ring and two nos tap with linking to a temporary leach pit with water supply arrangement. Roof to be covered either with GCI sheet or tarpaulin and false ceiling with ply and painting finishing in all respect.	2nos.		
5	Sweepers (Rate to be quoted per No. per shift.)	624 Nos.		
6	PH Plumber (Rate to be quoted per No. per shift.)	78 Nos.		

* *Taxes if any to be clearly indicated here with.*

Accepted

Contractor

**Sd/-
Managing Director
Orissa State Handloom Weavers'
Coop. Society Ltd. BBSR**



Sl. No.	Particulars	Number of required units	Rate per unit (in figure and words)	Total amount
1	2	3	4	5

EXTRA ITEMS

1	Providing boundary wall with clean GCI sheets on wooden poles/pillars wherever required.	Rate per running ft with 10' height.
2	Providing and fixing flag on stall poles 20' height with 3' x 6' size new satin cloth of different colour.	Rate per 1(one) no/day.
3	Providing of decorative approved design fascia for front side of the exhibition.	Rate per Sft.
4	Plastic molded chairs with arm.	Rate per 1(one) no/day.
5	Garden Chairs.	Rate per 1(one) no/day.
6	Extra sound system with stage light for cultural program.	Rate per day.
7	Preparation of a) cloth Banner as per approved design. b) Flex banner as per approved design	Rate per Sft.
8	Temporary structure with balli Pillar and bamboo structure with tarpaulin cloth ceiling and walling.	Rate per 1(one) Sft.
9	Decorative woolen carpet.	Rate per one sft.
10	Painting and lettering as per approved design.	Rate per Sft.
11	Roadside decorative light fittings.	Rate per one no per day.
12	100-Watts bulbs.	Rate per one no.
13	Metal Halide 400 watt /sunlight 400 watt.	Rate per one no. per day.
14	Mechanical Decorative light.	Rate per one no. per day.
15	Roadside Electrical Decorative structural light with miniature bulbs, size 3' x10'.	Rate per one no. per day.

Accepted

Contractor



Sl. No.	Particulars	Number of required units	Rate per unit (in figure and words)	Total amount
1	2	3	4	5
16	Providing and fixing of decorative 'T' lights.		Quote per one.	
17	Hiring charges of water tanker (Inbuilt unit with truck/ tractor with arrangement of water pump.) to be stationed at Exhibition Ground for full time (it is required to supply minimum five times by the tanker & tanker to be stationed for 24 hours at the Exhibition Ground.) i) 10,000 ltrs. Capacity. ii) 5,000 ltrs. Capacity.		Rate per day Rate per day	
18	Providing of Sandwich Man (Cartoon) for display/ publicity with Special Expo symbol.		Rate per one unit for entire expo period.	
19	Quote separately for extra fittings in the sales pavilion i.e. Light fittings, fans, chairs, racks counters etc.			
20	Electrical display gate in different location of the ground.			
21	Road Crossing display gate with balli pillars with bamboo structure covering with handloom cloth on wooden batten frame work as per approved design. a) Single Gate b) Double Gate			
22	Flower decoration to entire exhibitions stalls along with Theme Pavilion, Entrance Gate and other required place with provision of 30 nos. Flower Bouquet and Bouquet for 10 nos. Flower Vessels etc.		LS	

Accepted

Contractor



Sl. No.	Particulars	Number of required units	Rate per unit (in figure and words)	Total amount
1	2	3	4	5
23	Inaugural kits consisting a brass/silver decorative deepa stand, 500 gm ghee, a bundle of balita, one packet karpur, one match box, one packet of incense sticks, one roll red ribbon, one scissor, one tray covered with red velvet cloth, two nos colored candle etc as required for inaugural function.	LS		
24	Snacks packets in proper packaging consisting one samosa (singada), one vada (bara), one vegetable chop, one rasagola and one gulabjamun.		Rate to be quoted per packet.	
25	Sweets in gift packet with proper packaging consisting 1 Kg dry sweets like sandesh / kalakand / sonpampadi etc.		Rate to be quoted per packet.	
26	Salt kaju		Rate/1 Kg.	
27	Plain kaju		Rate/1 Kg.	
28	Salt biscuits		Rate/1 Kg.	
29	Mixtures		Rate/1 Kg.	
30	Green coconut (paida)		Rate/1 No.	
31	Cold drinks- 250 ml / 300 ml		Rate/1 Btl.	
32	Cold drinks- 1 ltr		Rate/1 Btl.	
33	Coffee		Rate/1 Cup.	
34	Tea		Rate/1 Cup.	
35	Fruits :			
	a. Grapes		Rate/1 Kg.	
	b. Orange			
	c. Apple			
36	Veg. food packets containing rice, dal, two vegetable curry, 2 nos chapatti/roti with salad and pickles.		Rate per 1 packet.	
37	Non-Veg. food packets containing rice, dal, one non-veg curry, 2 nos chapatti/roti with salad and pickles.		Rate per 1 packet.	

Accepted

Contractor



Sl. No.	Particulars	Number of required units	Rate per unit (in figure and words)	Total amount
1	2	3	4	5
38	Digital multi colour pamphlet/ Poster/Participation Certificate with paper 250 gsm- of approved design			
	a) A3 size	Rate per 1		
	b) A4 size	No		
	c) 1/8 size			
39	Leaf lets of 1/8 size with 110 gsm paper in digital multi colour	Rate per 1000 Nos.		
40	Conference folder			
	a) Executive folder	Rate per 1		
	b) Plain folder	No.		
41	Writing pad of size 19 cm x 22 cm containing 100 pages of paper 60 GSM both ruled and unruled of Times /Oxford/Navneet make.	Rate per 1 No.		
42	Writing pad of size 20 cm x 15 cm containing 80 pages of paper 60 gsm both ruled and unruled of Times / Oxford / Navneet make.	Rate per 1 No.		
43	Writing pen (use and throw type) of Montex / Reynold / Cello make etc.	Rate per 1 No.		
44	Diary of Times / Oxford / Archies make.			
	a) Executive	Rate per 1		
	b) Semi executive	No.		
	c) Organizer diary / Planner			
45	Distribution of leaf lets	Rate per 1000 Nos.		
46	Pasting of posters	Rate per 1 No.		
47	Flex banner in wooden frame work	Rate per 1 Sft.		
48	Flower bouquet-			
	a) Basket type	Rate per 1		
	b) Cone type	No.		
49	Mineral water-			
	a) 1 ltr bottle	Rate per 1		
	b) 20 ltr bottle	bottle		

Accepted

Contractor



Sl. No.	Particulars	Number of required units	Rate per unit (in figure and words)	Total amount
1	2	3	4	5
50	Use and throw cup and glass	Rate per 100 Nos.		
51	Bleaching	Rate per 1 Kg.		
52	Phenyl	Rate per 1 Ltr.		
53	Sanitol	Rate per 1 Ltr.		
54	Naphtholin	Rate per 1 Kg.		
55	Identity Card of approved design with Tag, Card holder and clip etc.	Rate per 1 No.		
56	Color Cartridge Set (4 Nos.) for Printer Model (HP Color Laser Jet 2600n)	Rate per 1 Set.		
57	Black Cartridge for HP 2600n Laser Printer	Rate per 1 No		
58	Computer Paper A4 size (JK BOND MAKE)	Rate per 1 Pkt		
59	Professional Grade C.C TV Video Equipment including High Solution Video Cameras, VCR, DVR, Video Surveillance Recorders, High Power Wireless Audio/Video link System. Camera 8 Nos. places in different position of Expo Ground with 2 Nos. Monitor and Wiring.	L.S		
60	Barricade- The basic structure is to be constructed with balli pillars and bamboo of 4' height with 4" thick and 1" depth railing to be fabricated with wooden frame work covering with approved design flex in 4 sites both in top and bottom rail and fixing of handloom motif /sarees made of flex of 4' width and 4' height in each 8' gap.	1 Rft		

**Accepted
Contractor**



Sl. No.	Particulars	Number of required units	Rate per unit (in figure and words)	Total amount
1	2	3	4	5
61	Decorative kalasa consisting with 3 numbers earthen pots with traditional painting including cost of green coconut and mango leaf.	1 Set		
62	Preparation of artificial fountain with all cost of material and labour charges.	1 Unit		
63	Preparation of traditional Goddess Mandap with stone / brick with different statue and coloring and painting with traditional jhoti under the existing tree inside the Expo premises.	1 Unit		
64	Ad through Auto by pesting 2 Ft. x 2 Ft. Vinyle Sticker in backside of Auto for one month time.	1 No.		
65	(A) 85 watt CFL bulb	Per No / per day		
	(B) 65 Watt CFK Bulb	Per No / per day		
	(C) 45 Watt CFL Bulb	Per No / per day		
	(D) 18 / 20 Watt CFL Bulb	Per No / per day		

Accepted

Contractor

Sd/-
Managing Director
Orissa State Handloom W.C.S Ltd,
Bhubaneswar



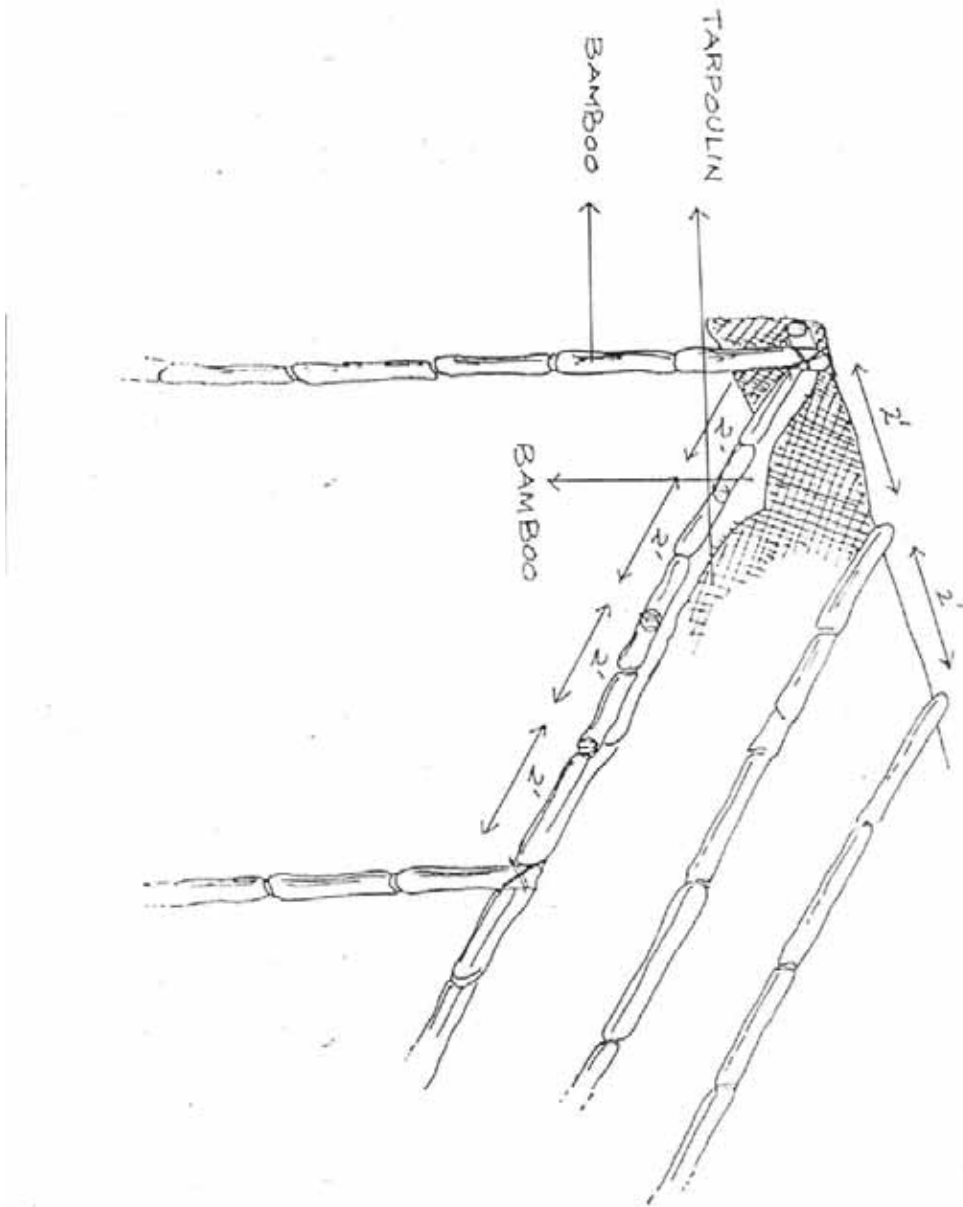

Drawing No-1

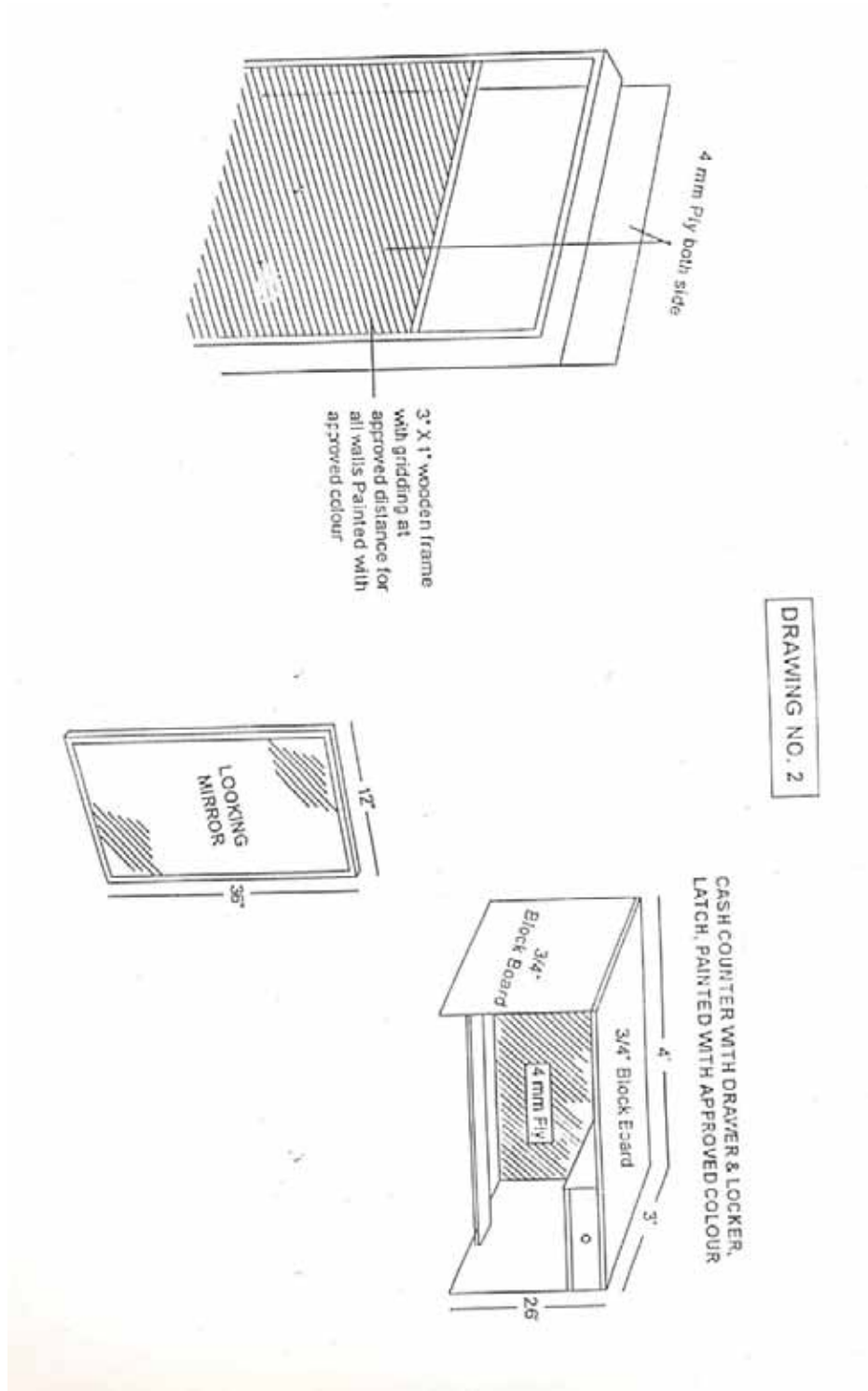

Drawing No-2

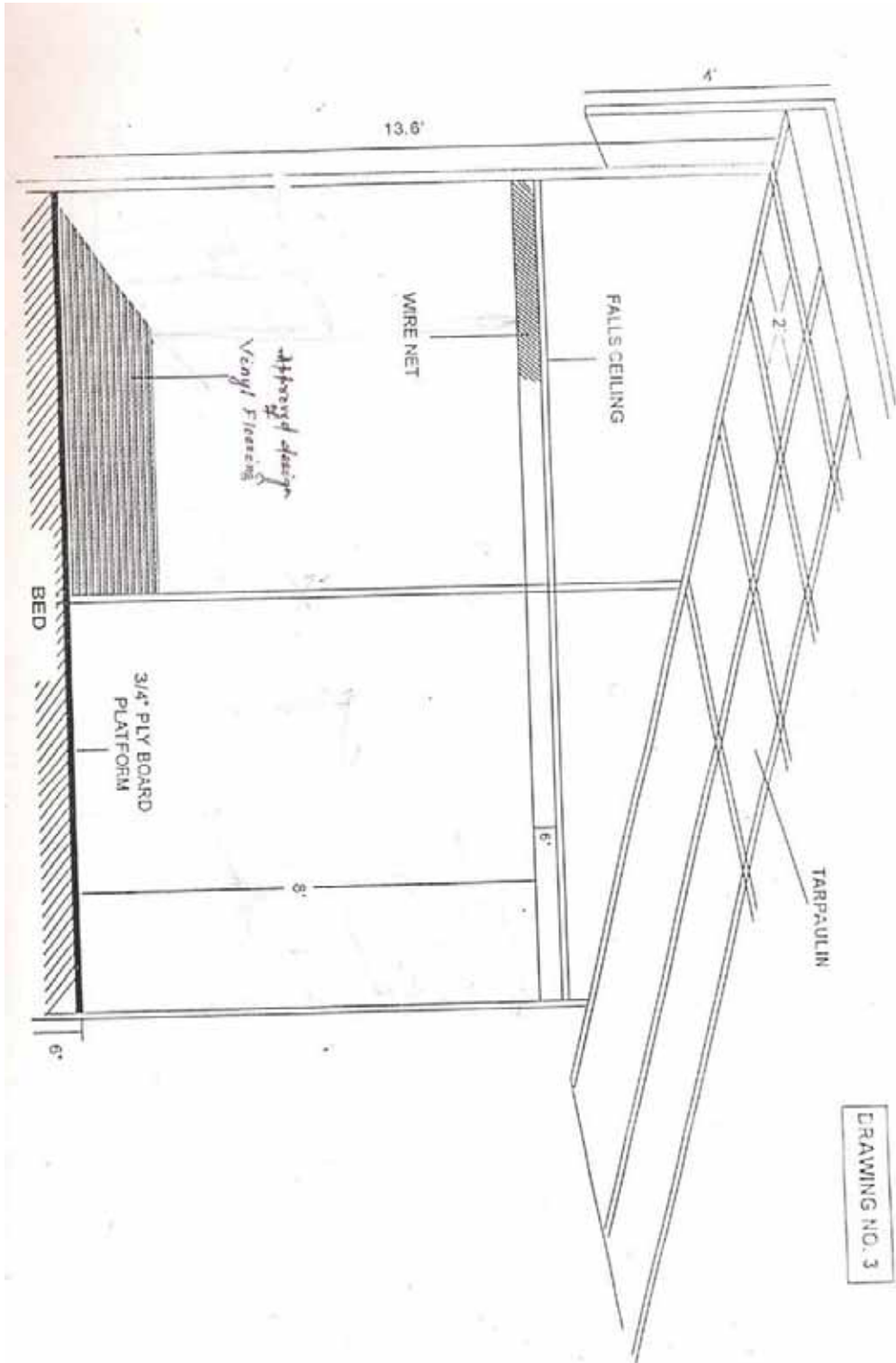

Drawing No-3

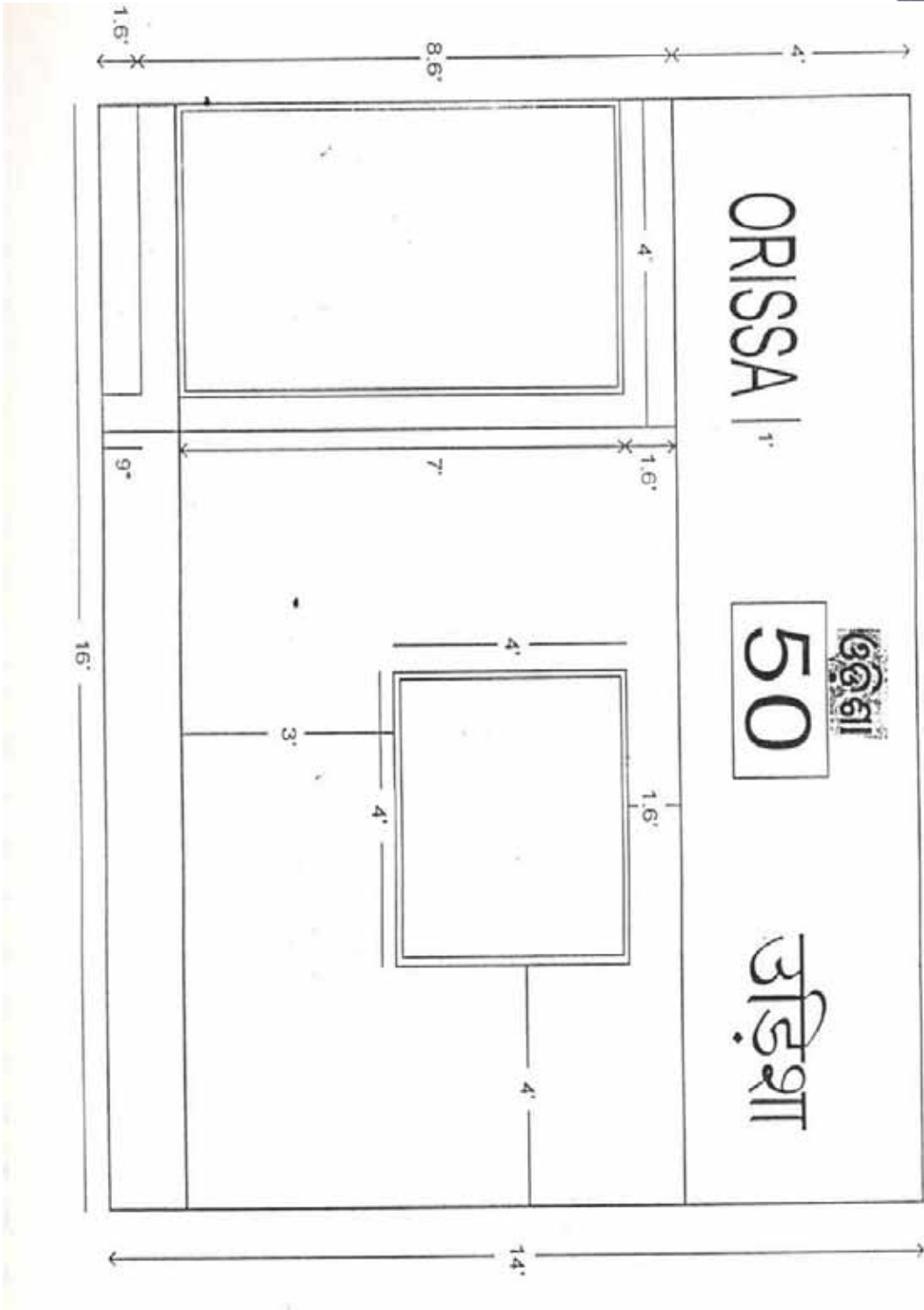

Drawing No-4

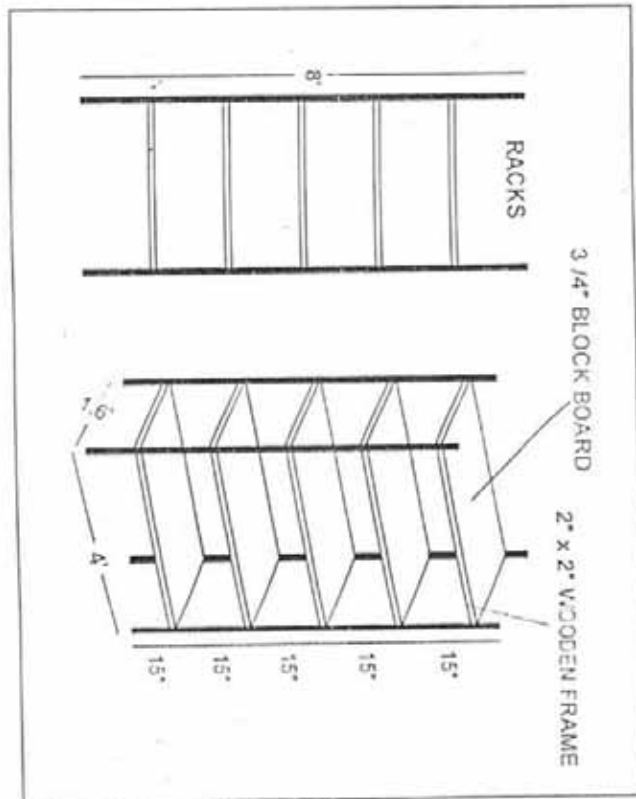
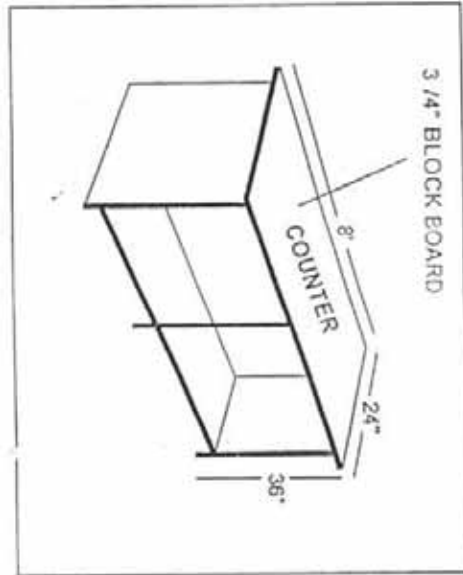

Drawing No-5

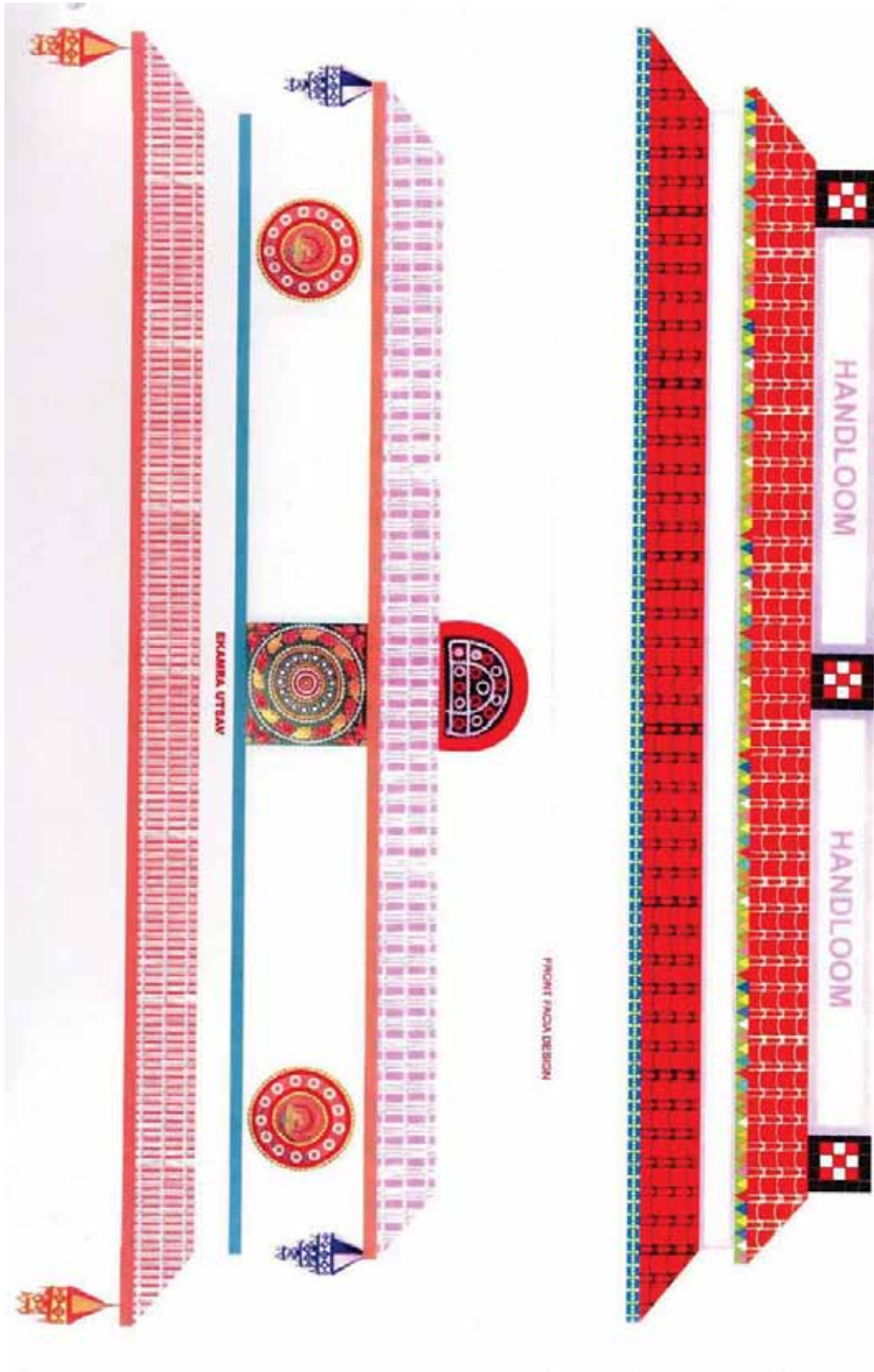

Drawing No-6



REFERENCE DRAWING - THEME PAVILION



Drawing No-7 A



Reference Drawing - Thimma Pavilion

Drawing No-7 B



Gate Design of **Handloom Expo**

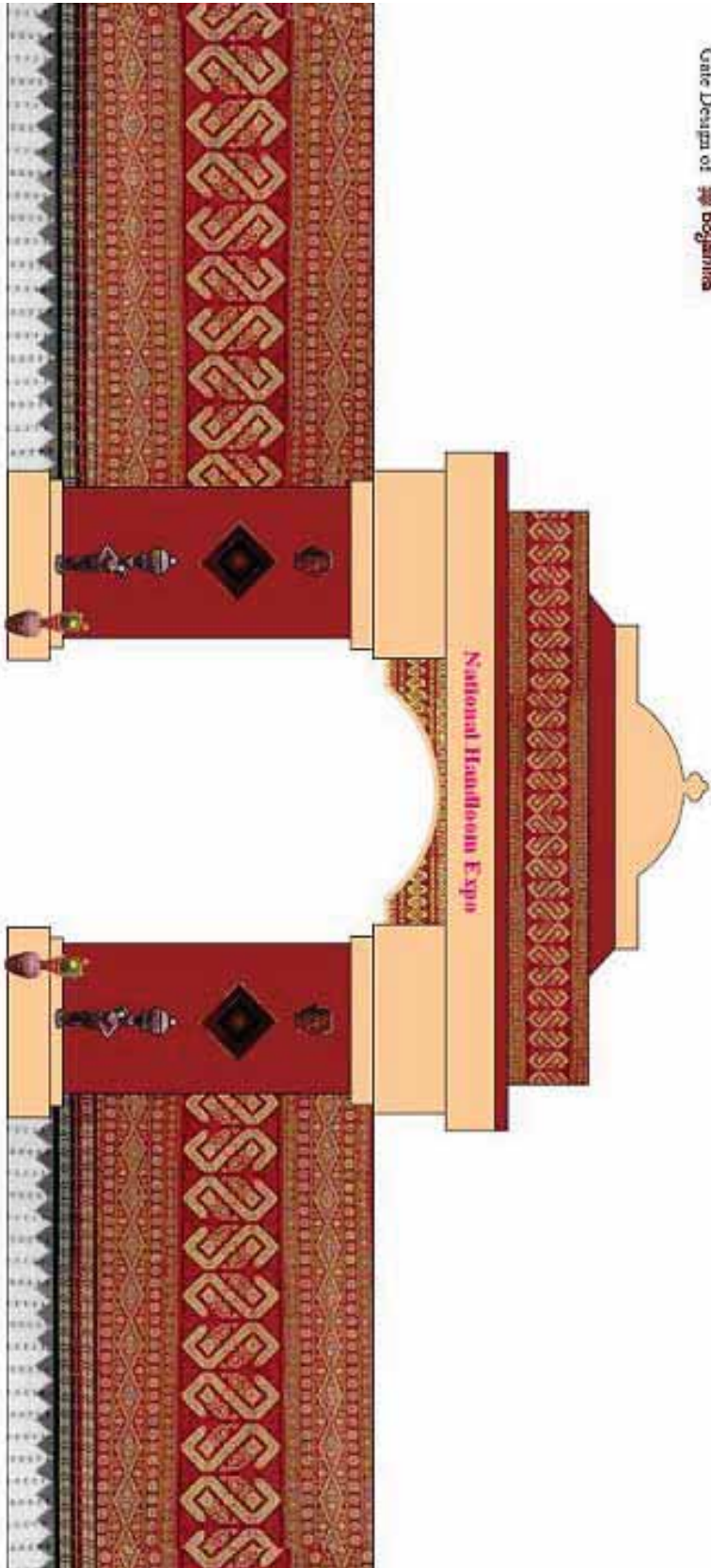



Gate Design of **ଝାଁ ବାଗିଚା**

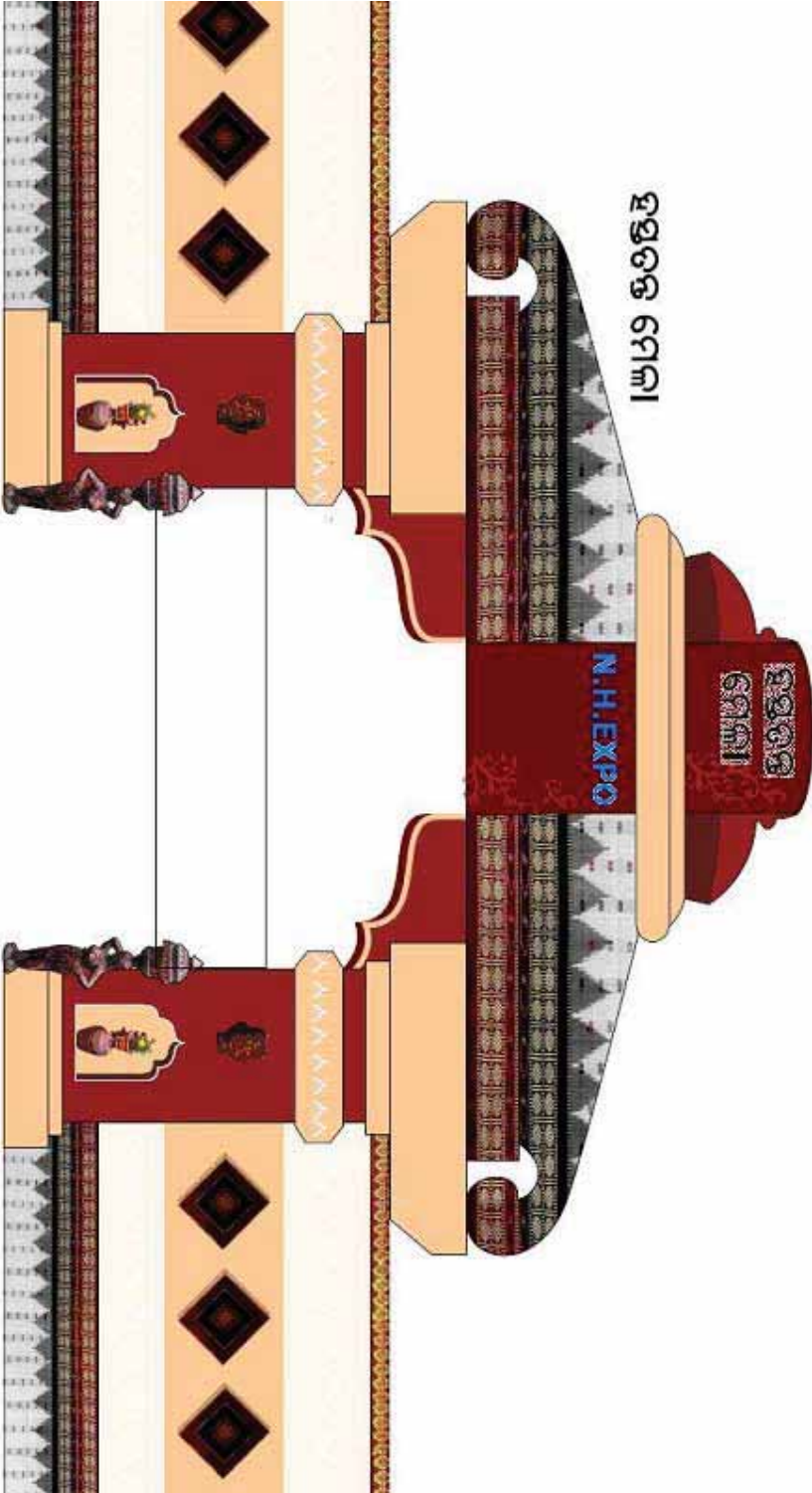



Gate Design of  baganika

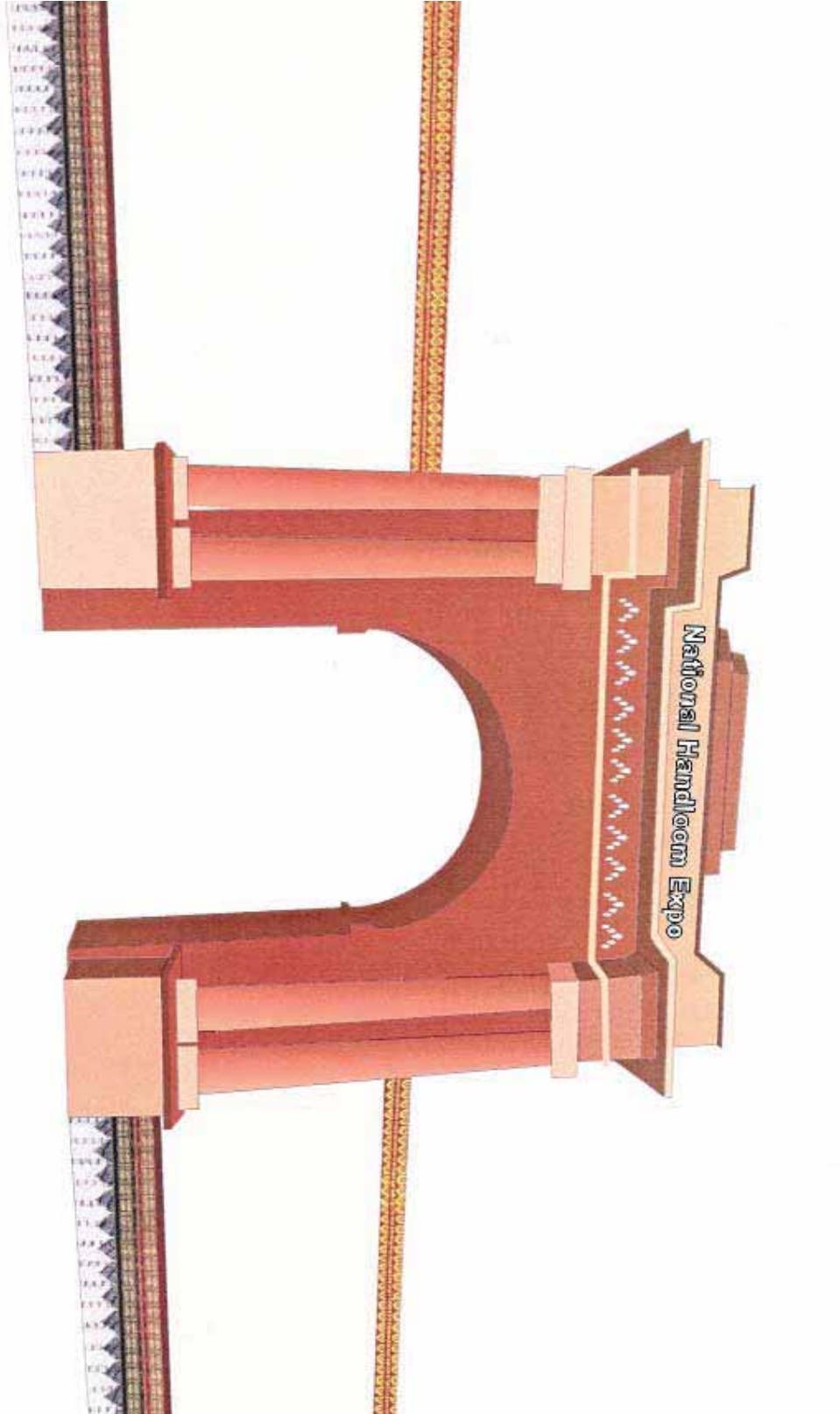



Gate Design of  bgyanika

